

MBL-SF-484/1~20mW

LD PUMPED ALL-SOLID-STATE BLUE LASER

CNI's All solid state at 484nm blue laser features of ultra compact, long lifetime, low cost and easy operating, which is used in laser display, medical treatment, scientific research, etc.



SPECIFICATIONS

Wavelength (nm)	484±1
Operating mode	CW
Output power (mW)	>1, 2, ...,20
Power stability (rms, over 4 hours)	<3%, <5%
Transverse mode	Near TEM ₀₀
Beam divergence, full angle (mrad)	<3
Beam diameter at the aperture (1/e ² ,mm)	~4
Beam height from base plate (mm)	100
Warm-up time (minutes)	<10
Operating temperature (°C)	15~30
Power supply (90-264VAC)	PSU-W-FDA
Expected lifetime (hours)	10000
Warranty period	1 year

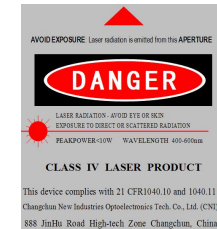

MBL-SF-484

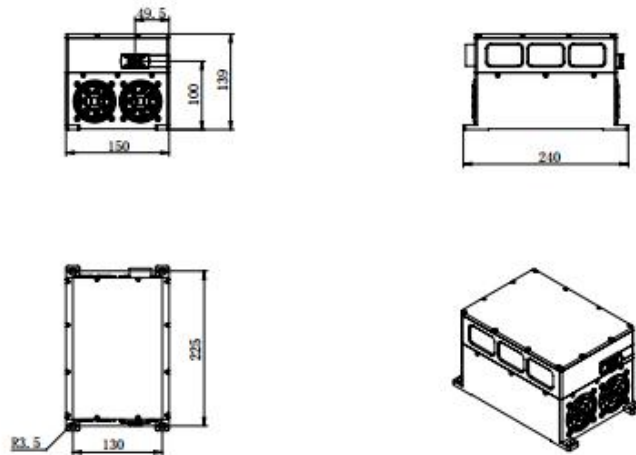

240(L)×150(W)×139(H) mm³, 7.5kg

PSU-W-FDA

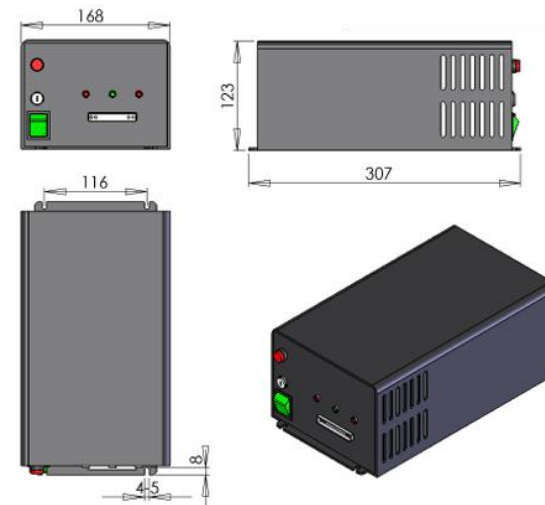

307 (L) ×168(W) ×123(H) mm³, 4.5kg



长春新产业光电技术有限公司

Changchun New Industries Optoelectronics Tech. Co.,Ltd.

DATA SHEET