

# 980nm Laser Diode

## ■ Features

- Output Power: 50mW (CW)
- Efficient Quantum Well Structure
- Standard TO-18 Package



## Outline Dimension

### TO-18 Package

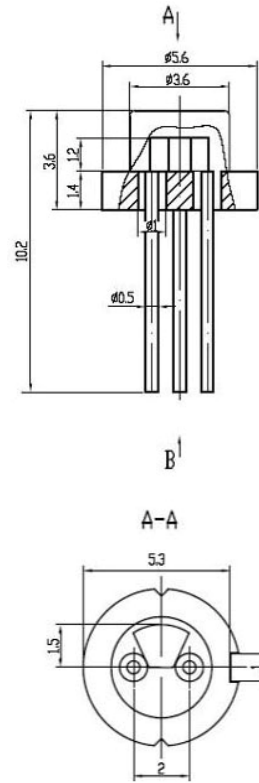

(Unit: mm)

## ■ Absolute Maximum Ratings

(Tc=25°C)

Item	Symbol	Absolute Maximum Ratings	Unit
Optical Output Power	Po	50	mW
LD Reverse Voltage	Vr (LD)	2	V
Storage Temperature	Tstg	-40~85-	°C
Operating Case Temperature	Tc	10~40	°C

## ■ Initial Electrical/Optical Characteristics

(Tc=25°C)

Item	Symbol	Typ.	Unit
Optical Output	Po	50	mW
Peak Wavelength*	$\lambda_p$	980±10	nm
Threshold Current	Ith	≤0.025	A
Operating Current	Iop	≤0.12	A
Slope Efficiency	$\eta$	≥0.45	W/A
Operating Voltage	Vop	≤2.0	V
Horizontal Beam Divergence	$\theta_{//}$	≤25	deg.
Vertical Beam Divergence	$\theta_{\perp}$	≤35	deg.
Wavelength Temperature Coefficient		0.3	nm/°C
Polarization		TE	

\* Measuring specifications.

All figures in this specification are measured by CNI's method and may contain measurement deviations.

## Pin Connection

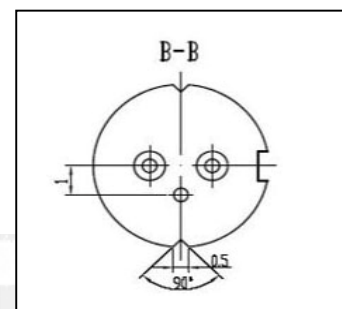

The above specifications are for reference purpose only and subjected to change without prior notice.



Changchun New Industries Optoelectronics Tech. Co., Ltd

<http://www.cnilaser.com>

## ◆ CONTACT

No.888, Jinhua Road, High-tech zone, Changchun 130103, China

Phone: 0086-431-87033597

Fax: 0086-431-87033597