

MRL-SF-612/1~100mW

LD PUMPED ALL-SOLID-STATE RED LASER

CNI's DPSS laser at 612nm features ultra compact, long lifetime and easy operating, it is widely used in communication, medical treatment, scientific research, etc.



SPECIFICATIONS

Wavelength (nm)	612±1
Operating mode	CW
Output power (mW)	>1,10, 50, ... , 100
Power stability (rms, over 4 hours)	<3%, <5%
Transverse mode	Near TEM ₀₀
Beam divergence, full angle (mrad)	<2
Beam diameter at the aperture (1/e ² ,mm)	~4
Polarization ratio	>100:1
Beam height from base plate (mm)	100
Warm-up time (minutes)	<10
Operating temperature (°C)	15~30
Power supply (90-264VAC)	PSU-W-FDA
Expected lifetime (hours)	10000
Warranty period	1 year



MRL-SF-612

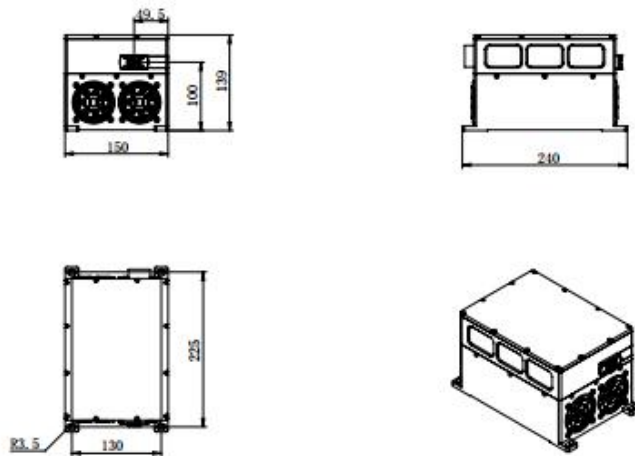

240(L)×150(W)×139(H) mm³, 7.5kg

PSU-W-FDA

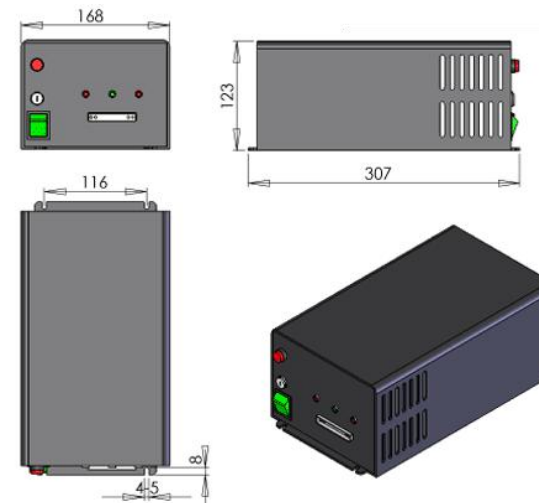

307 (L)×168(W)×123(H) mm³, 4.5kg