

Features

Output Power: 20mW (CW)
Standard TO-18 Package

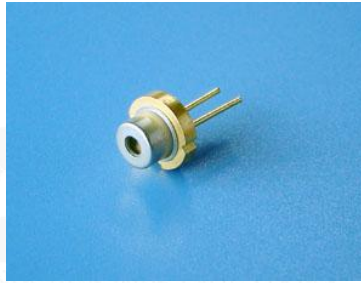

Absolute Maximum Ratings

(Tc=25°C)

Item	Symbol	Absolute Maximum Ratings	Unit
Light Output Power	Po	20	mW
LD Reverse Voltage	Vr (LD)	2	V
PD Reverse Voltage	Vr (PD)	30	V
Storage Temperature	Tstg	-40~85	°C
Operating Case Temperature	Tc	-10~50	°C

Initial Electrical/Optical Characteristics

(Tc=25°C)

Item	Symbol	Typ.	Unit
Optical Output	Po	20	mW
Peak Wavelength*	λ_p	635±5	nm
Threshold Current	Ith	60	mA
Operating Current	Iop	80	mA
Slope Efficiency	η	1.0	mW/mA
Operating Voltage	Vop	2.3	V
Horizontal Beam Divergence	$\theta_{//}$	8	deg.
Vertical Beam Divergence	θ_{\perp}	16	deg.

* Measuring specifications.

All figures in this specification are measured by CNI's method and may contain measurement deviations.

The above specifications are for reference purpose only and subjected to change without prior notice.

Outline Dimension

TO-18 Package

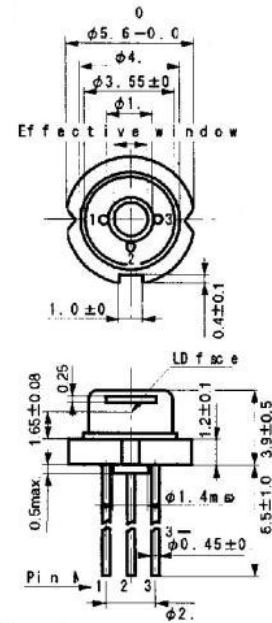

(Unit: mm)

Pin Connection

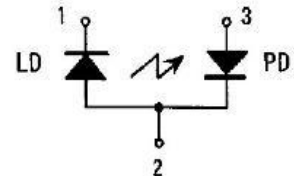

▲

AVOID EXPOSURE-LASER RADIATION IS EMITTED FROM THIS APERTURE

DANGER

LASER RADIATION-AVOID DIRECT EXPOSURE TO BEAM
Maximum Output: 500 mW Wavelength: 400-700 nm

CLASS IIIb LASER PRODUCT

This device complies with 21 CFR 1040.10 and 1040.11
Changchun New Industries Optoelectronics Tech. Co., Ltd.
No. 888 Jinhua Road, High-tech Zone, Changchun, China

