

MDL-NS-1550/1-10mW



**NANOSECOND PULSED
INFRARED DIODE LASER
AT 1550nm**

This series laser products with excellent material removal rate, are widely used in microelectronics, material processing, solar energy and medical equipment manufacturing, etc.



SPECIFICATIONS

Central wavelength (nm)	1550±10
Operating mode	Pulsed
Peak power (mW) ¹	1-10
Power stability (rms, 4 hours ± 3°C)	<2%, <1%, <0.5%
Pulse width (FWHM)	10ns-10ms
Transverse mode	Near TEM ₀₀
M ²	<1.5
Beam diameter at the aperture (1/e ² ,mm)	~1.5
Beam divergence, full angle (mrad)	<3.0
Rep. rate ²	DC-10MHz
Rise Time (ns)	<5
Fall Time (ns)	<5
Modulation Depth (extinction ratio)	>1000000:1
Warm-up time (minutes)	<5
Cooled method	Conduction
Beam height from base plate (mm)	19
Operating temperature (°C)	10-35
Operating voltage (VDC)	12V/3.34A
Expected lifetime (hours)	>10000

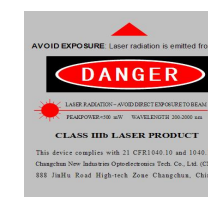

LASER HEAD (DRIVER Integrated)³

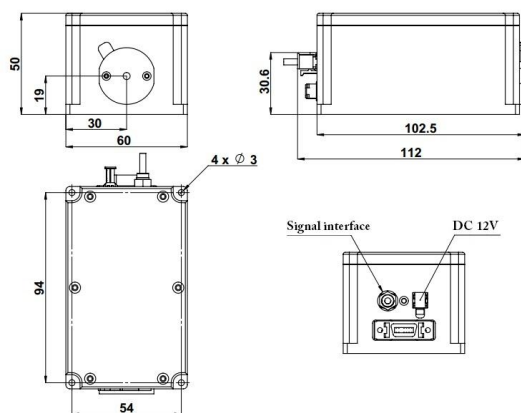

112 (L) × 60 (W) × 50 (H) mm³, 0.5kg

POWER SUPPLY (100-240VAC) optional

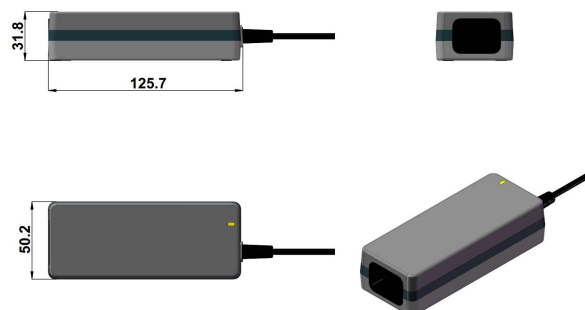

125.7 (L) × 50.2 (W) × 31.8 (H) mm³, 0.3kg

MULTIFUNCTIONAL PULSE TRIGGER optional

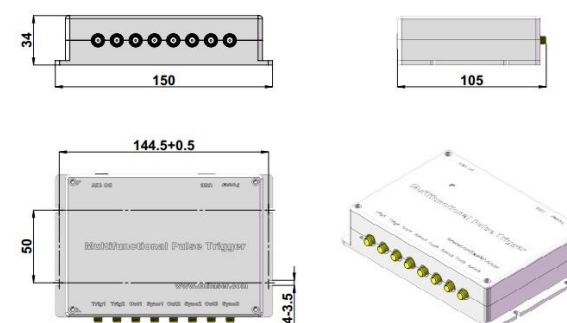

150 (L) × 105 (W) × 34 (H) mm³, 0.5kg

1 Any power level can be selected in this range.

2 Both internal and external triggers are acceptable. The internal trigger is provided by a Multifunctional Pulse Trigger with a frequency range of DC-10MHz.

3 RS232 control optional, output power adjustable 10-100% by software.